

Williamson County Inner Loop Annex

Directions:

From IH-35 South (Round Rock area)

Exit 259
Stay on Frontage Road for about 2 miles
Right at Stop sign onto Inner Loop
Past Snead Drive is the Inner Loop Annex on the Left

From IH-35 North (Georgetown area)

Exit 259
Turn Left (to go under highway)
Straight at Stop sign onto Inner Loop
Past Snead Drive is the Inner Loop Annex on the Left

Building Layout:

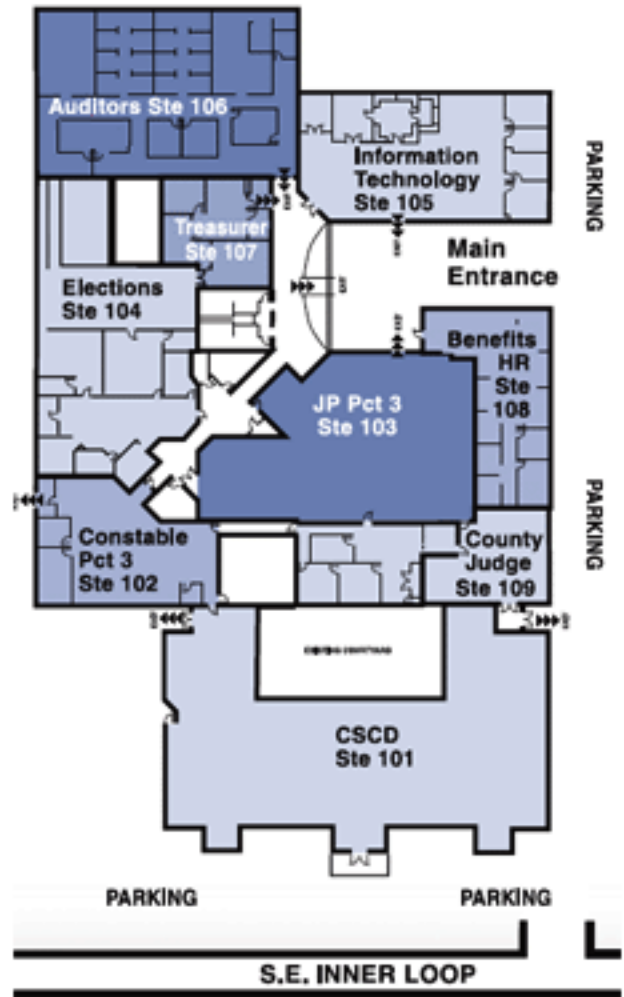

Location Map:

